

## Want some guidance on using your phone?

On your phone, check out our friendly walkthroughs in the **Tips & Help** app. For self-help in troubleshooting basic problems, you can use the **HTC Guide** app. Or go to [www.htc.com/support/](http://www.htc.com/support/) to find tutorials, the user guide, FAQs, latest news, and more.

Please also read the Safety and regulatory guide that's included in the box.

Complies with  
IDA Standards  
DB 104368

© 2014 HTC Corporation. All rights reserved.

HTC, the HTC logo, and HTC Butterfly are trademarks of HTC Corporation.

microSD is a trademark of SD-3C LLC.

All other company, product and service names mentioned herein are trademarks, registered trademarks or service marks of their respective owners.



91HOxxxx-xxM Rev.A

htc.com

# HTC Butterfly 2

## Inserting your nano SIM and storage cards

### IMPORTANT: USE A STANDARD NANO SIM ONLY.

Don't cut a micro SIM or regular SIM card and insert it into the nano SIM slot. It's thicker than the standard nano SIM card and may get stuck in the slot.

Make sure your phone is off. With the phone facing up, the nano SIM slot is on the right side and the microSD™ slot on the left.

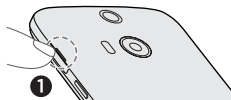

1. Insert your fingertip in the small opening on the right side of the phone, and then pull the nano SIM tray out.

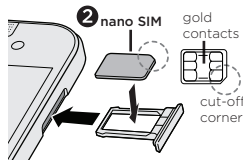

2. Make sure the phone and the nano SIM tray are facing up. Place your nano SIM card into the tray, with the gold contacts facing down and cut-off corner facing out.

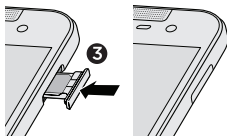

3. To reinsert the nano SIM tray, center it first in the slot, and then slide it all the way in.

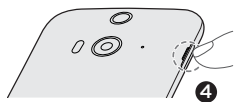

4. Insert your fingertip in the small opening in the left side of the phone, and then pull the microSIM tray out.

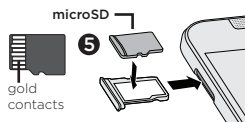

5. Make sure the phone and the microSD tray are facing up. Place your microSD card into the tray, with the gold contacts facing down.

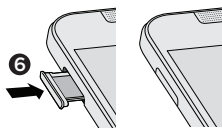

6. To reinsert the microSD tray, center it first in the slot, and then slide it all the way in.

### To prevent water from entering the slots:



After sliding the nano SIM and microSD trays into the slots, slide your finger several times across the cover that's attached to the tray, to ensure that it's closed evenly and firmly. Make sure the cover doesn't protrude from the side.

### Things to know about waterproof protection

HTC Butterfly 2 meets the IPX7 waterproof standard. This means that if you accidentally drop this phone in water, it is protected from water under these conditions:

- The nano SIM and microSD covers are closed firmly. (See previous page for details.)
- The phone is immersed in plain tap water within 1 meter deep and for less than 30 minutes.

In addition to the above, take the following precautions to help protect the phone:



- Avoid immersing the phone or letting the USB port and headset jack come in contact with liquid chemicals such as liquid soap or detergent. Also, never immerse the phone in sea water, the swimming pool, hot springs, or any liquid besides water (such as alcohol).

In case the USB port and headset jack have had contact with salt water or liquid chemicals, rinse using fresh water. These contaminants may damage the connector pins.

- If the USB port and headset jack got wet, hold the phone with these ports facing up and shake off the water. Make sure to let the ports dry completely before using the phone.
- Keep the phone away from sand.

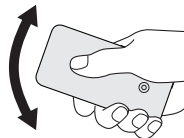

See the user guide for more details on waterproof protection for HTC Butterfly 2.